

Allowable Loads lbs (kN) ^A					
Chord	Allowable Loads ^{A,B}	Clip on one face ^B		Clip on both faces	
		TS6WTC3	TS1WTC3	TS6WTC3	TS1WTC3
28TSC2.75	U	550 (2.45)		1750 (7.78)	
	P1	880 (3.91)		1750 (7.78)	
33TSC2.75	U	550 (2.45)		2180 (9.70)	
	P1	1090 (4.85)		2180 (9.70)	
43TSC2.75	U	550 (2.45)		3240 (14.41)	
	P1	1620 (7.21)		3240 (14.41)	
28TSC4.00	U	880 (3.91)		1750 (7.78)	
	P1	880 (3.91)		1750 (7.78)	
33TSC4.00	U	1090 (4.85) ^C		2180 (9.70)	
	P1	1090 (4.85)		2180 (9.70)	
43TSC4.00	U	1370 (6.09) ^C		3240 (14.41)	
	P1	1620 (7.21)		3240 (14.41)	
54, 68, and 97TSC4.00	U	1370 (6.09) ^C		3530 (15.70)	4340 (19.31)
	P1	1640 (7.30)		3290 (14.63)	

- A. Allowable loads shown are not in combination.
B. Connections with clip on one face require a web above connection.
C. If web above connection is 33W1.5x.75, U = 910 lbs (4.05 kN). If web above connection is 33C1.5x1.5, U = 1000 lbs (4.45 kN).
D. P2 = 340 lbs (1.51 kN) for clip on one face.
P2 = 880 lbs (3.91 kN) for clip on both faces.

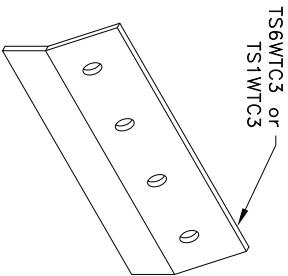

TS6WTC3
bare metal thickness (t) = 0.0538 in. (1.37mm)
TS1WTC3
bare metal thickness (t) = 0.128 in. (3.25mm)

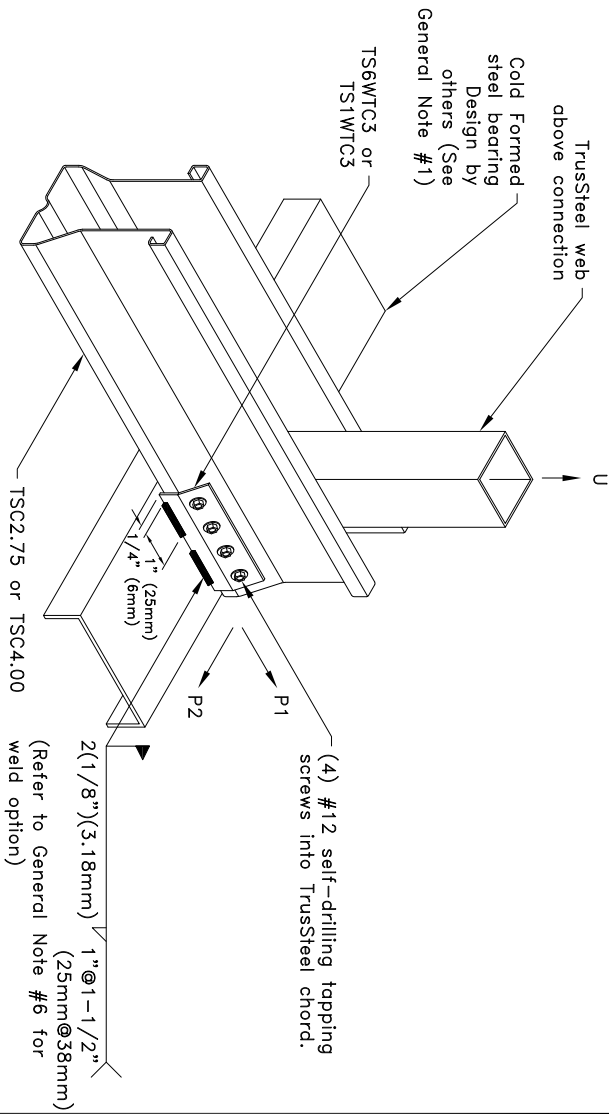

General Notes:

- Bearing shall be manufactured from Cold-Formed Steel (CFS) with minimum tensile strength of 45 KSI (310 MPa), minimum bare metal thickness, t = 0.0538" (1.37 mm) and maximum width of 3-5/8" (92 mm).
- Attachment of second clip on opposite face of chord is identical to what is detailed.
- Design of bearing shall be by others.
- Refer to TrussSteel Technical Bulletin 98.10.05 titled "Repair of Galvanized Surfaces" to restore corrosion resistant properties of the connection after welding.
- Weld values are based on a filler material with a minimum tensile strength of 70 ksi (483 MPa).
- In lieu of welds specified above, the full length of the TS6WTC3 / TS1WTC3 may be welded to the bearing.
- Cold-formed steel calculations are per the AISI 2007 North American Specification for the Design of Cold-Formed Steel Structural Members (AISI S100-2007).

TrussSteel[®]
An ITW Company

www.TrussSteel.com

Florida: 1950 Manley Drive / Haines City, FL 33844 / (800) 755-6001
Missouri: 13389 Lakefront Drive / Earth City, MO 63045 / (800) 326-4102
California: 8351 Rovana Circle / Sacramento, CA 95828 / (800) 877-3678

**TS6WTC3 or TS1WTC3
Welded Truss Clip to
Cold-Formed Steel Bearing
Using #12SDS**

ITW Building Components Group, Inc. shall not be responsible for any performance failure in a connection due to a deviation from this detail. Any variation from this detail shall be approved in advance by ITW Building Components Group, Inc.

Custom Detail:

TS-CD-TB-CF10-002

Date:

04/21/11

Custom Detail Category:

Truss-To-Bearing Connection